

GB 1. CONTROL CENTRE B-2003

1.1 Instructions for control centre use

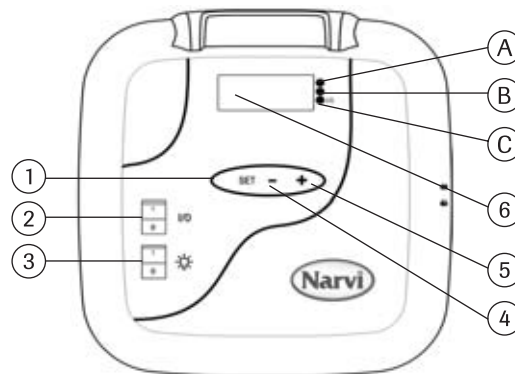

1. Menu, the functions of the scrolling key starting from the basic display:
First press, adjustment of pre-selection time.
Second press, adjustment of switching-on time.
Third press, adjustment of target temperature.
Fourth press, measured temperature.
2. When the display is off, pushing the I/O switch will switch on the control centre. When the switch is turned to position I, the pre-selection time will be displayed.
The pre-selection time remains on the display for 5 seconds, and then the measured temperature is displayed. When the measured temperature appears on the display, the heating resistors are switched on.
3. Light switch for sauna.
4. Adjustment of time and temperature.
5. Adjustment of time and temperature.
6. Display.

1.2 Setting of clock

1. Press the SET key and hold it down until the hours start to flash.
Use the +/- key to set the hours.
2. Press the SET key again and minutes will start flashing. Set the minutes.
3. Press the SET key again to set the day using the +/- key.
1= Monday... 7= Sunday
4. One more pressing of the SET key will display and store the set time.

1.3 Programming of weekly clock

When the clock has been set, you can set the weekly clock.

1. Press the SET key and hold it down until the green signal light is switched on. You can now start the programming of the first memory location.
2. The total number of memory locations is 7 and they are shown on the display separated by hyphens. E.g. -1-
Choose the memory location with the +/- key.
3. After you have chosen the memory location, press the SET key, and the START hours start to flash. Set the start hours with the +/- key.
4. Press the SET key again, and the START minutes start to flash. Set the start minutes with the +/- key.
5. Press the SET key again, and the STOP hours start to flash. Set the stop hours with the +/- key.
6. Press the SET key again, and the STOP minutes start to flash. Set the stop minutes with the +/- key.
7. Press the SET key again to set the starting day 1-7 (1= Monday... 7= Sunday).
If the starting day is set at 0, the memory location is not in use. For example, even if the start and stop time have been set, but the starting day is set at 0, the stove will not be switched on at the set time.
8. When you have set also the starting day, press the SET key once more, and you can choose the next memory location with the +/- key.
9. If you do not wish to program any more memory locations, do nothing and the control centre will return to the basic display.

When the weekly clock is programmed, the control centre automatically checks the correct relationship between switching-on time and switching-off time. If the switching-on time exceeds 12 hours or the time between switching-off time and new switching-on time is less than 6 hours, the control centre issues error message ERR4 and the programming will not be stored.

1.4 Signal light indications

- A. Red light = on until the set temperature is reached for the first time.
- B. Yellow light = flashes when the pre-selection time is displayed (time runs down).
Yellow light = on when the remaining switching-on time is displayed.
- C. Green light = flashes when adjustment of the target temperature is possible.

1.5 Error messages

- ERR1= A break in the sensor circuit.
- ERR2= A short-circuit.
- ERR3= A break in the overheat protector's current circuit.
- ERR4= Error in weekly clock programming.

NOTE! When an error message is displayed, the sauna stove is switched off.

1.6 Technical data

- Temperature adjustment range 40°C-115°C
- Temperature display 20°C-125°C
- In increments of 1°C
- Pre-selection time max. 24h
- In increments of 1/2 h
- If pre-selection time is 1 hour or less, in increments of 1 min.

2. CONTROL CENTRES T-2003 and NAE-2003

2.1 Instructions for control centre use

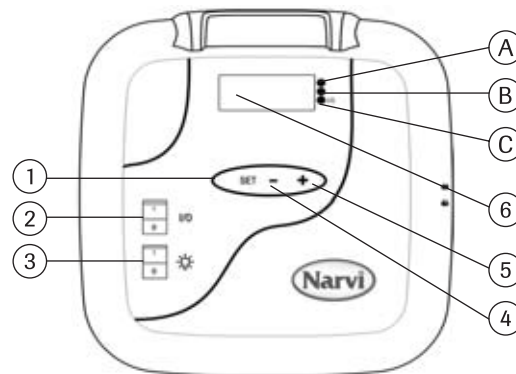

1. Menu, the functions of the scrolling key starting from the basic display:
First press, adjustment of pre-selection time.
Second press, adjustment of switching-on time.
Third press, adjustment of target temperature.
Fourth press, measured temperature.
2. When the display is off, pushing the I/O switch will switch on the control centre. When the switch is turned to position I, the pre-selection time will be displayed.
The pre-selection time remains on the display for 5 seconds, and then the measured temperature is displayed. When the measured temperature appears on the display, the heating resistors are switched on.
3. Light switch for sauna.
4. Adjustment of time and temperature.
5. Adjustment of time and temperature.
6. Display.

2.2 Signal light indications

- A. Red light = on until the set temperature is reached for the first time.
- B. Yellow light = flashes when the pre-selection time is displayed (time runs down).
Yellow light = on when the remaining switching-on time is displayed.
- C. Green light = flashes when the set temperature is displayed.
Green light = on, when light is on in the sauna.

2.3 Error messages

- ERR1= A break in the sensor circuit.
- ERR2= A short-circuit.
- ERR3= A break in the overheat protector's current circuit.

NOTE! When an error message is displayed, the sauna stove is switched off.

2.4 Technical data

- Temperature adjustment range 40°C-115°C
- Temperature display 20°C-125°C
- In increments of 1°C
- Pre-selection time max. 24h
- In increments of 1/2 h
- If pre-selection time is 1 hour or less, in increments of 1 min.

3. Installation of sensor box

- For control centres T-2003 and B-2003 the sensor box is installed as shown in Fig. 2

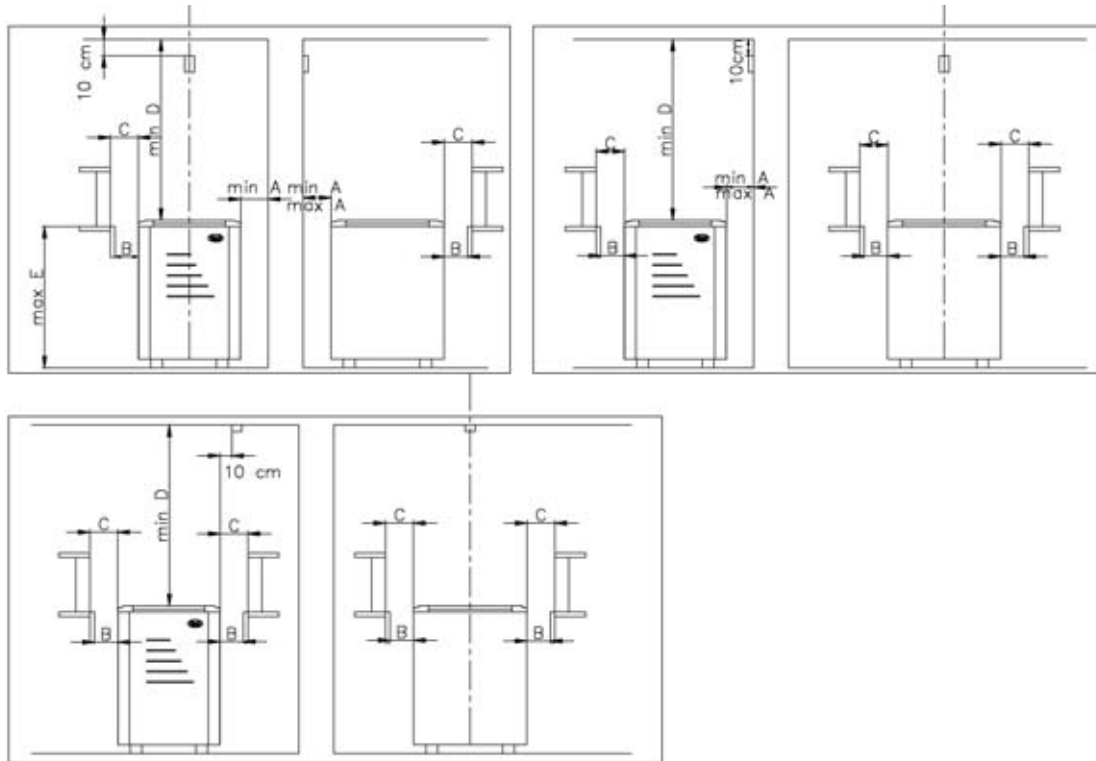

Fig. 2. Installation of sensor box

- For control centre NAE-2003 the sensor box is installed as shown in Fig. 3

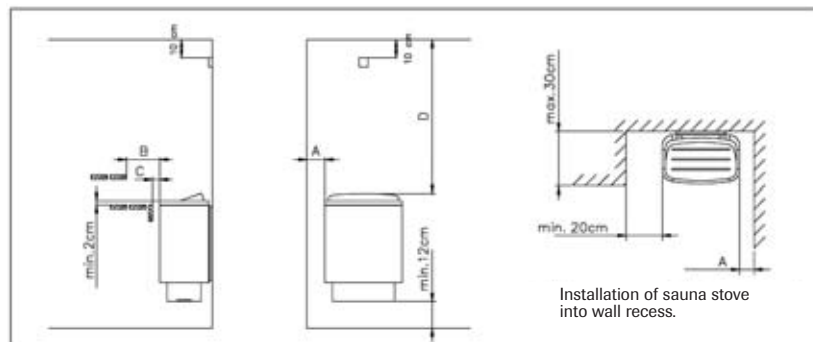

Fig. 3. Installation of sensor box

4. Installation of control centre

- The control centre is not suited for flush mounting. Fig. 4.
- The control centre shall be installed outside the sauna room.

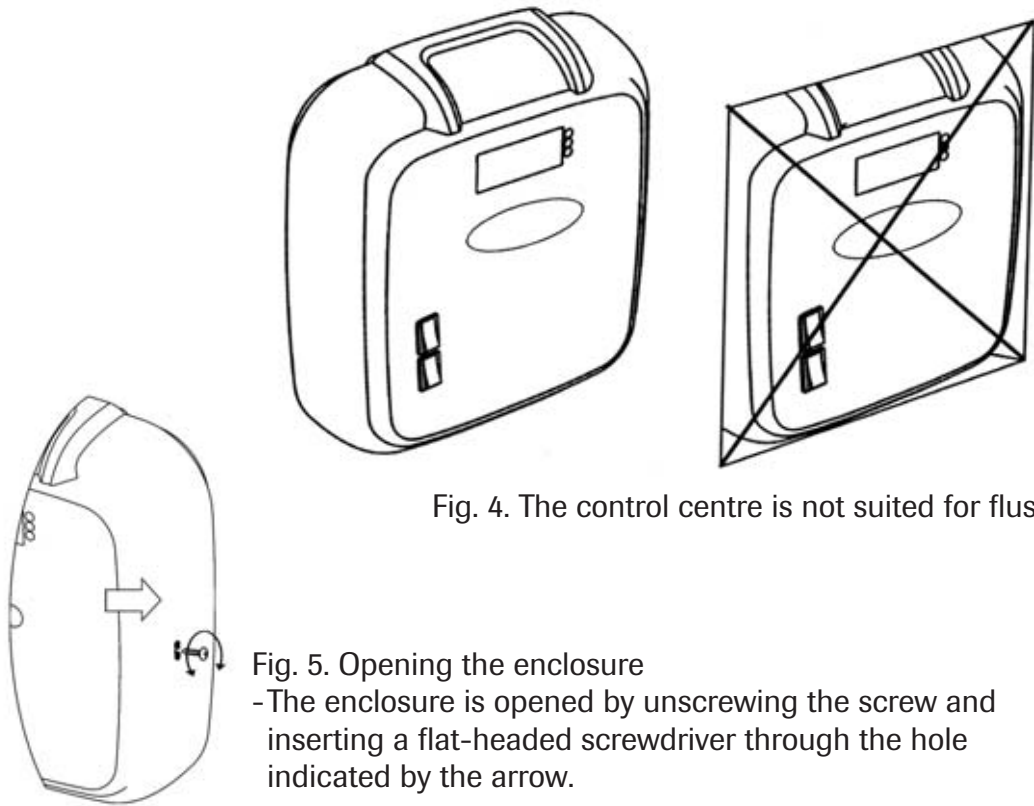

Fig. 4. The control centre is not suited for flush mounting.

Fig. 5. Opening the enclosure

- The enclosure is opened by unscrewing the screw and inserting a flat-headed screwdriver through the hole indicated by the arrow.

- The enclosure is fixed on the wall with three screws. Fig. 6.

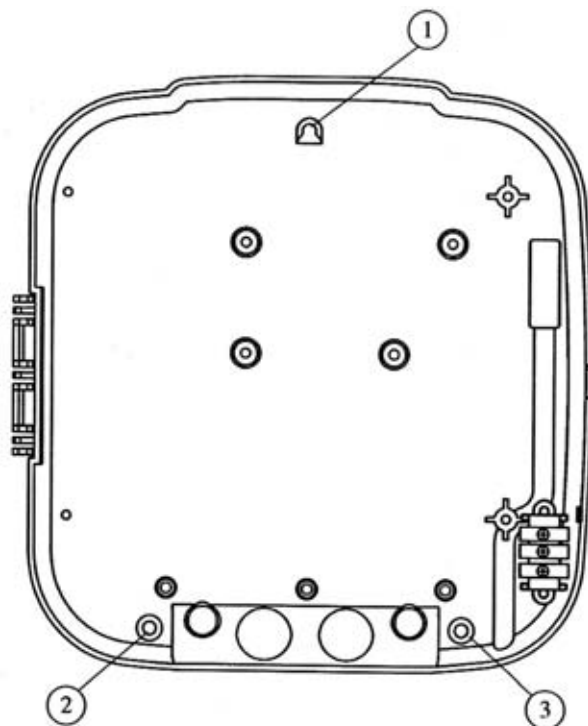
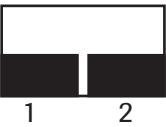
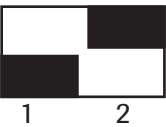



Fig. 6. Fixing of the enclosure

5. Changing of switching-on time

Position of DIP switch (J8)	Max. switching-on time
<p>ON</p>  <p>1 2</p>	4 h
<p>ON</p>  <p>1 2</p>	6 h
<p>ON</p>  <p>1 2</p>	12 h

- The maximum switching on time can be changed by the fitter using the DIP switches inside the control centre.

NOTE!

- 4 h and 6 h for family and public saunas
- 12 h only for public saunas

6. Connection diagram

